

Central Park – Goldy S. Lewis Community Center & James L. Brulte Senior Center

11200 Base Line Road. Rancho Cucamonga, CA 91701

Operating Hours | Monday – Friday 8:00 a.m. – 8:00 p.m. & Saturday 8:00 a.m. – 5:00 p.m.
 Extended hours are for facility rental use only.

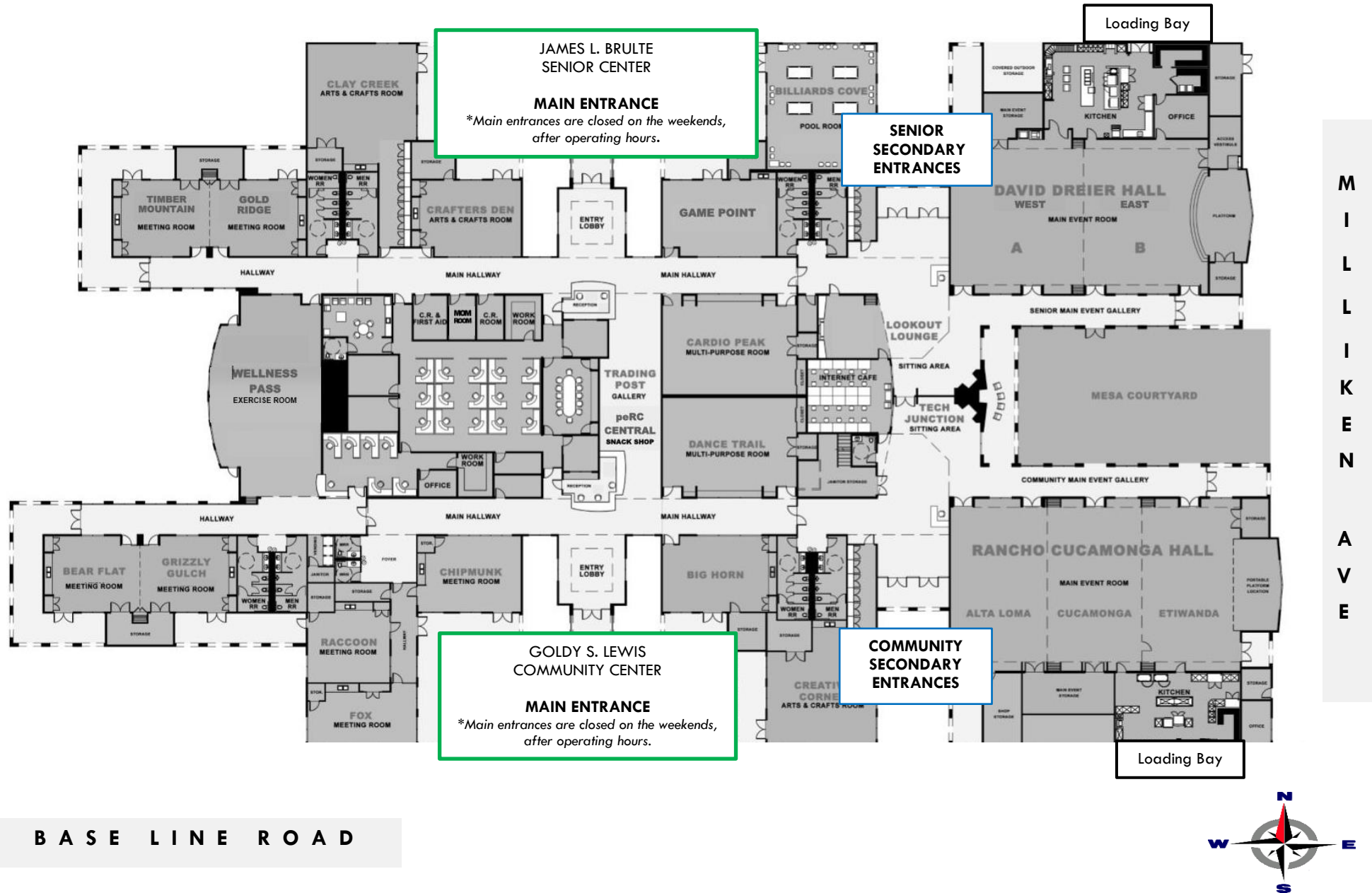

CENTRAL PARK – ROOM CAPACITIES & SQUARE FOOTAGE

NOTE: Adding additional equipment around the perimeter of your room layout, will impact & take away from seating.

ROOM SIZE	SQUARE FT.	THEATER	CLASSROOM	BANQUET <i>w/DF = DANCE FLOOR</i>
Medium Event Hall <i>w/ catering kitchen</i>	3,192	300	36 x 6 ft. tables = 108	24 x 60" Rounds = 192 20 x 60" Rounds w/DF = 160
Large Event Hall <i>w/ catering kitchen</i>	4,512	400	42 x 6 ft. tables = 126	32 x 60" Rounds = 256 30 x 60" Rounds w/DF = 240
Mesa Courtyard <i>*Tables and chairs are not provided.</i>	5,040	250	N/A	150-200 <i>*Tables and chairs are not provided.</i>
Large Rooms <i>(One section of event hall. Excluding Saturdays)</i>	1700 <i>Approx.</i>	130	20 x 6 ft. tables = 60 <i>per section</i>	12 x 60" Rounds = 96 9 x 60" Rounds w/DF = 76 <i>per section</i>
Large Rooms <i>(One section of event hall w/ stage. Excluding Saturdays)</i>	1,344	130	15 x 6 ft. tables = 45	8 x 60" Rounds = 64 7 x 60" Rounds w/DF = 56
Large Room <i>w/ semi-private grass area</i>	1,246	100	15 x 6 ft. tables = 45	9 x 60" Rounds = 72
Large Room <i>w/ semi-private cement patio</i>	1,246	100	15 x 6 ft. tables = 45	9 x 60" Rounds = 72
Medium Rooms	1,140	75	17 x 6 ft. tables = 56	8 x 60" Rounds = 64
Dance Rooms	1,344	25	N/A	N/A
Small Rooms	750	50	10 x 6 ft. tables = 30	5 x 60" Rounds = 40

Rental activities and events held at City facilities must comply with facility capacity limits as set by fire regulations.
The rental applicant must present staff with an approved event plan (diagram or layout) to ensure that the event does not exceed facility capacity limits.